

LONG BEACH ISLAND HOME DESIGN MAGAZINE

OPEN HOUSE

INTERIOR & EXTERIOR DESIGN

MEDIA KIT 2024





OPEN HOUSE is the only publication entirely dedicated to home design in the Long Beach Island market and surrounding areas. Whether capturing the sweeping views from an oceanfront home or the relaxed atmosphere of a home designed for family living, the photographs and editorial will engage our readers to understand how the various spaces inside and out relate to each other. The magazine will feature editorial on interior and exterior treatments, kitchen, bath, home technology, landscape design, art, furniture and much more.

OPEN HOUSE will truly bring to life the diverse architecture that encompasses life in the Long Beach Island and the surrounding areas.

DEMOGRAPHIC PROFILE

91% WILL SPEND OVER \$20,000 ON THEIR HOME DURING THE YEAR

94% AGREE THAT MY SUMMER HOME IS MY RETREAT

90% WILL MAKE A MAJOR DECISION ON THEIR HOME IN THE NEXT 24 MONTHS

93% OWN A HOME ON LBI

CIRCULATION & DISTRIBUTION

4,000 copies will be distributed for the Spring 2024 issue.
Displayed prominently on Long Beach Island and vicinity,
plus 30,000 Digital Copies.

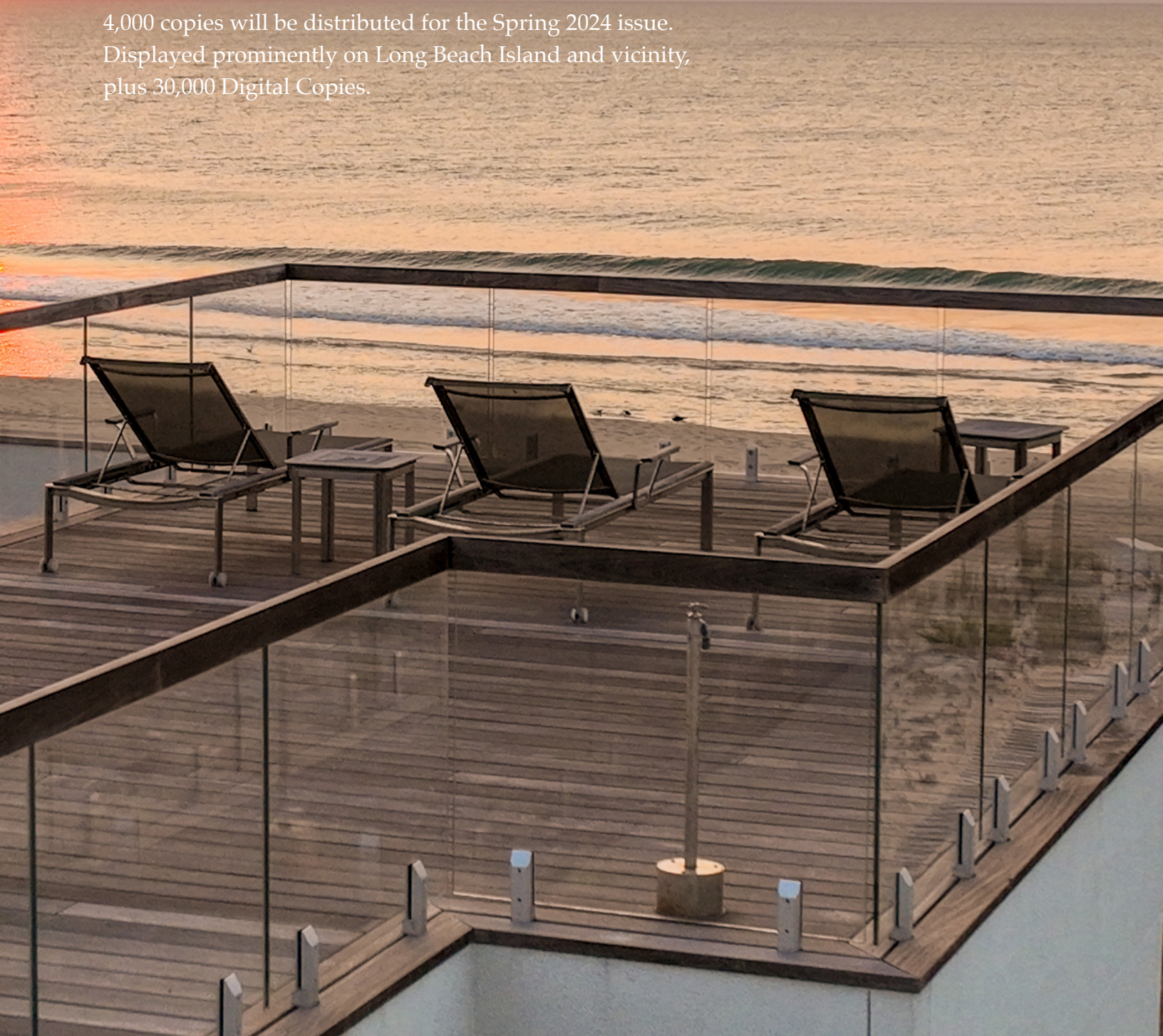



AD SPECS

SIZE	BLEED	TRIM
Full Page	8.625" x 10.75"	8.375" x 10.5"
Spread	17" x 10.75"	16.75" x 10.5"
1/2 Horizontal	7.3785" x 4.7517"	7.2375" x 4.625"
1/2 Vertical	3.6875" x 9.5"	3.5625" x 9.375"

Build ad trim size and extend bleed 5/8" beyond trim on all sides. Supply spreads as spreads, all other ads as single pages. All ads must be saved as PDF (300dpi) high-resolution with a hard copy proof. All images and files must be CMYK. All Artwork, images and fonts must be included when file is saved as PDF (high-resolution). All spot colors must be converted to CMYK.

PRINT RATES

SIZE	SPRING
Full Page	\$1,600
Double Page Spread	\$3,100
1/2 Horizontal	\$800
1/2 Vertical	\$800
Inside front cover	\$1,600
Inside back cover	\$1,600
Page facing inside cover	\$1,800
Page 5	\$2,000
Page 7	\$1,900
Page 9	\$1,700
Inside center fold	\$3,100

CALENDAR

SPRING
issue

In home May

AD CLOSE

3/11/24

EDITORIAL CONTENT

Interior Design



Kitchen & Bath



Architecture



Landscape Design



Art



Home Technology



OPEN HOUSE MAGAZINE IS THE TOP RESOURCE FOR CONSUMERS WHO WANT TO TAP INTO DESIGN AND ARCHITECTURE COMMUNITIES IN THE LONG BEACH ISLAND AND SURROUNDING AREA.



CONTACT US

CO-FOUNDER | CHAIRMAN | PUBLISHER

Gary Henderson

gary@bay-mag.com
203.240.4269

CO-FOUNDER | CREATIVE EDITORIAL DIRECTOR

Farrell Dunleavy

farrell@bay-mag.com
203.240.8233

HEADQUARTERS

227 N 13th Street
Surf City, NJ 08008

info@bay-mag.com